

## INSTALLATION MANUAL RECESSED TRIMLESS

### INDEX

- A:** SINGLE UNIT INSTALLATION
- B:** CONTINUOUS INSTALLATION
- C:** CORNER INSTALLATION
- D:** WIRING DETAILS



#### WARNING:

The safety and warranty of this fixture is guaranteed only if installed in compliance with below instruction manual.

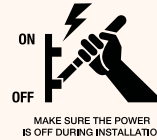

**IP20**

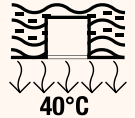

THE LOW SURFACE TEMPERATURE (40°C) IMPOSE NO LIMITS ON INSTALLATION

### A. SINGLE UNIT INSTALLATION

#### Provided Components

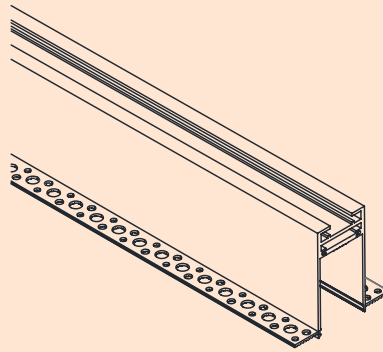

Specter trimless profile-(x1)

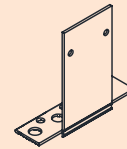

End Cap-(x2)

1.

- Cut ceiling opening (consult factory shop drawings for cut-out opening dimensions). Pull the low voltage cables through the ceiling opening.

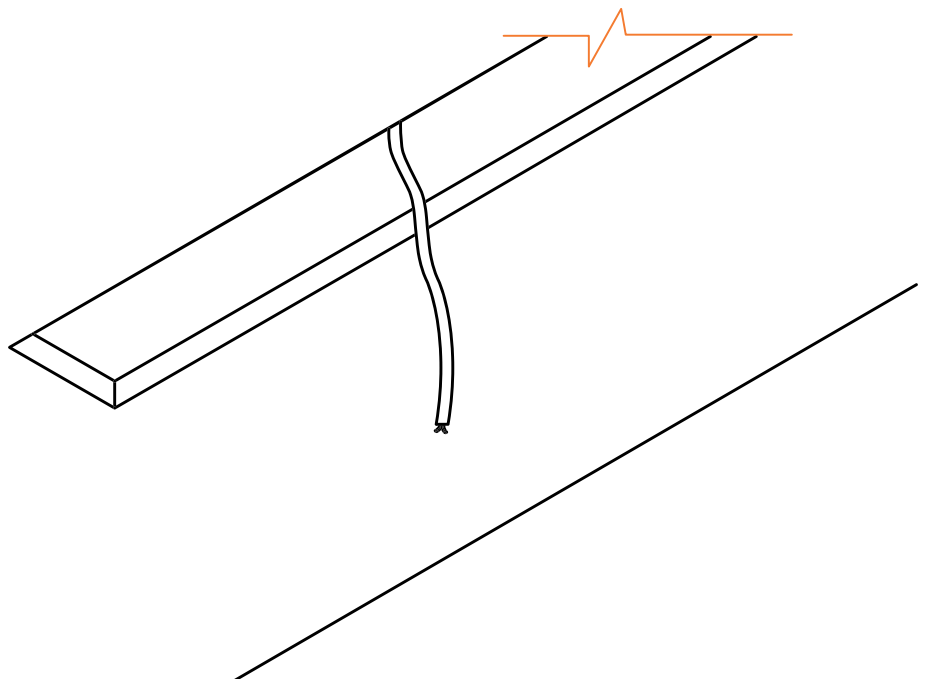

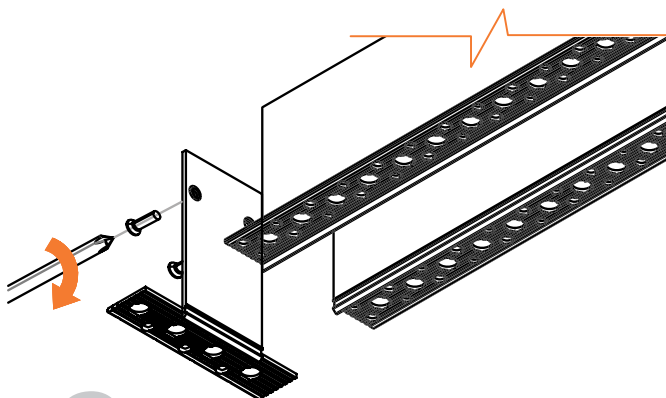

2.

- Screw the end caps on both sides of the profile.

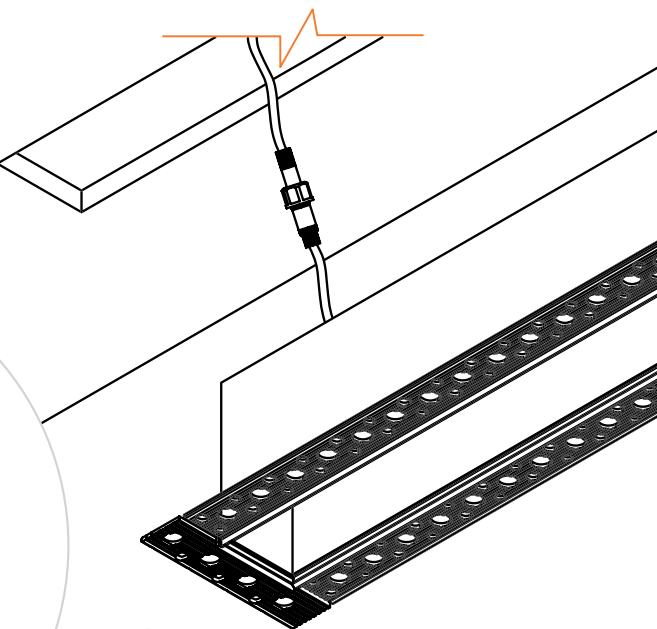

3.

- Connect the profile cables to the low voltage feed.

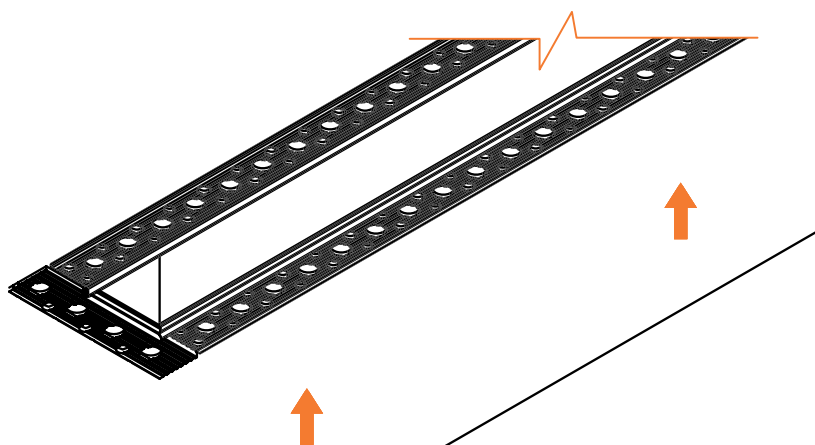

4.

- Insert profile in opening.



**WARNING:** Failure to secure safety cables can lead to injury or death!



**WARNING:** Shock hazard. Serious injury or death may occur. Turn Off power before servicing or installing. Wire according to local and national codes. This product shall be installed by a qualified electrician.



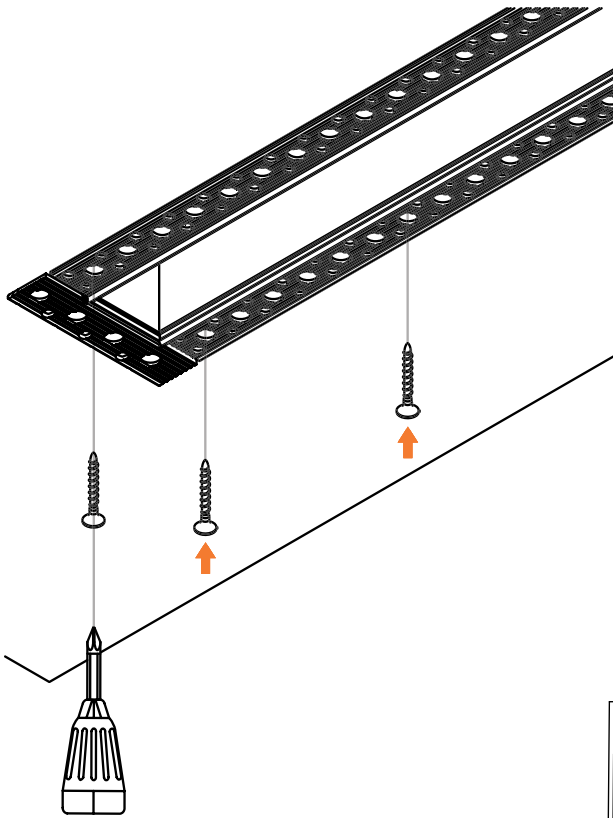

5. ▶ Fasten the profile in place with screws compatible with the mounting surface.

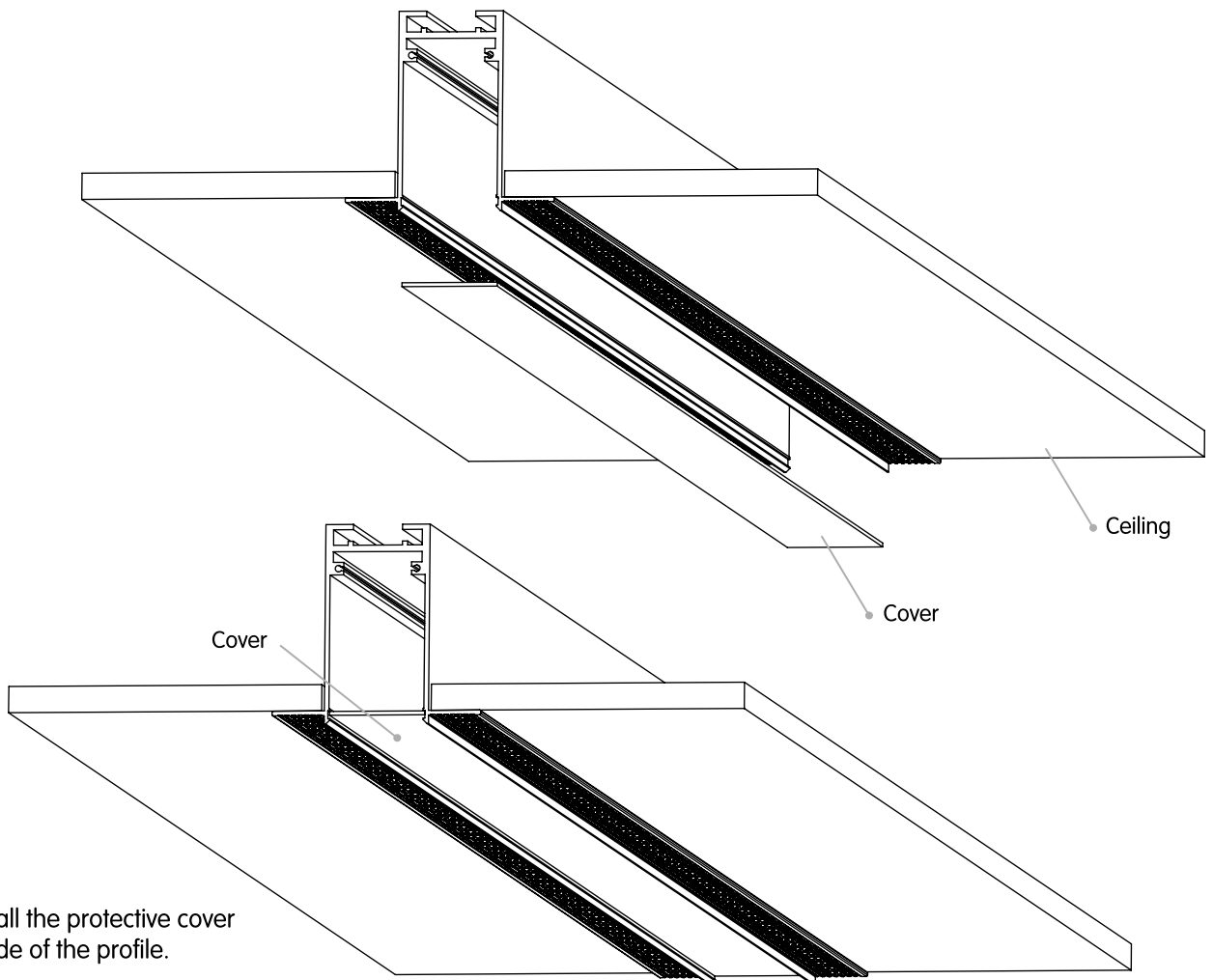

6. ▶ Install the protective cover inside of the profile.

7.

► Apply mesh tape on the mud-flange.

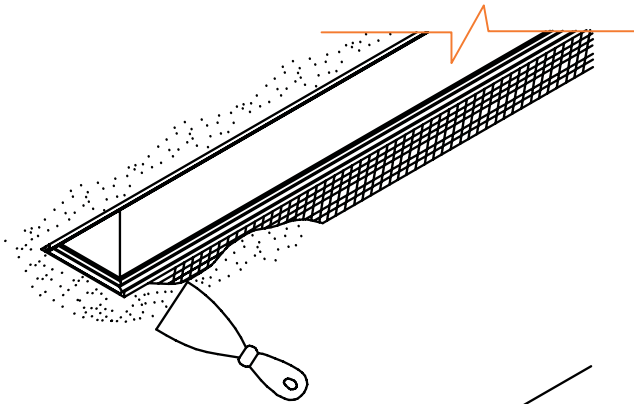
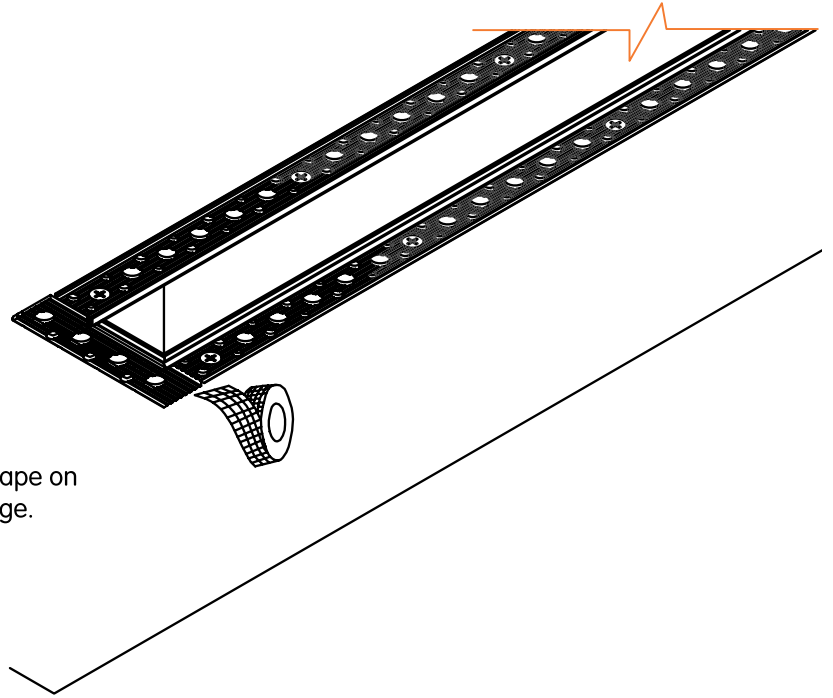

8.

► Spackle the plaster on the mesh tape.

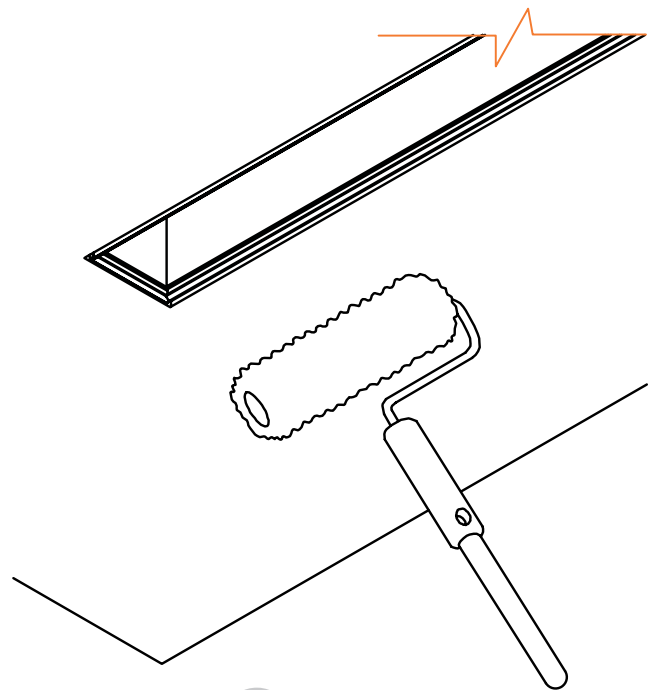

9.

► Finish and paint ceiling.



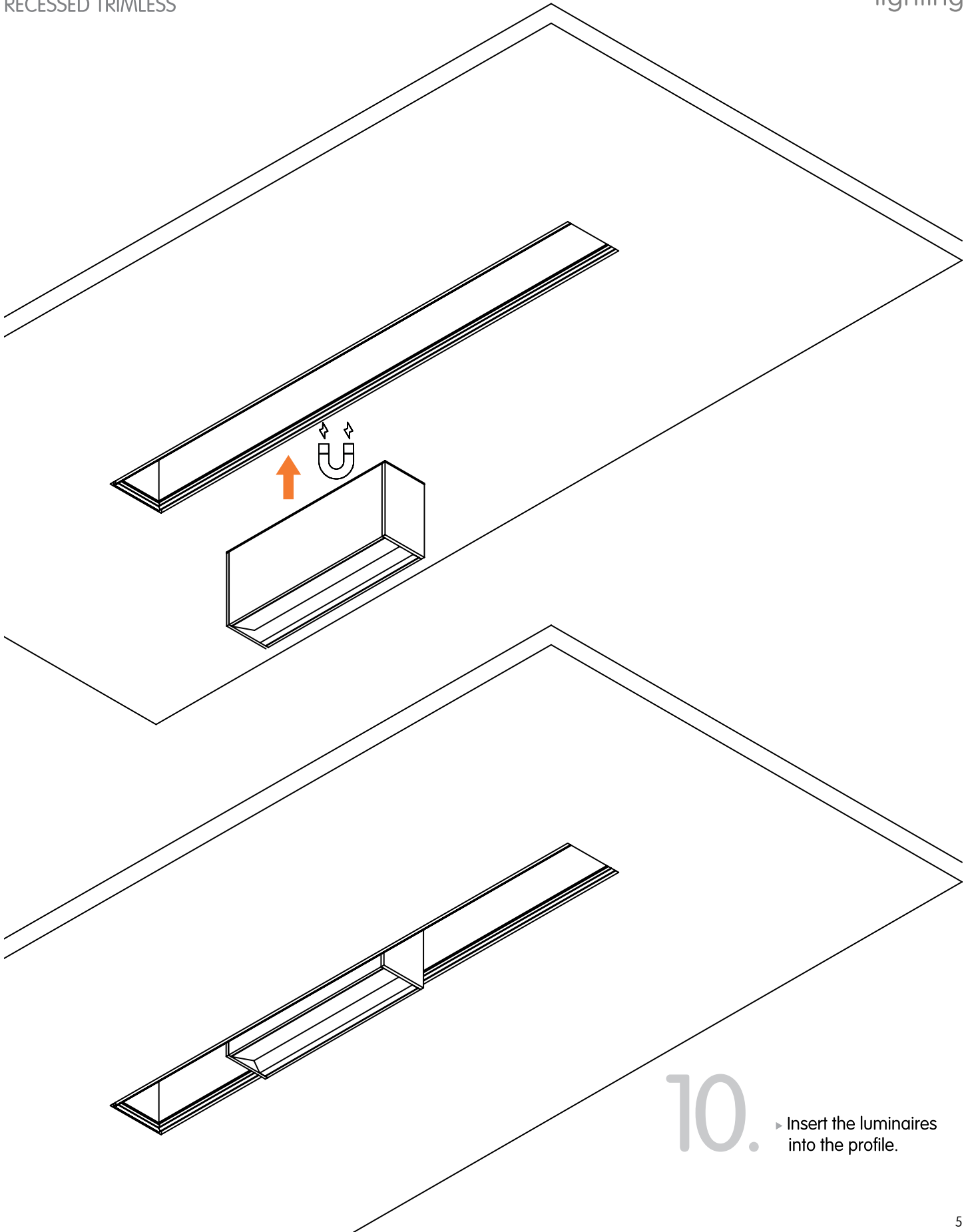

10. ▶ Insert the luminaires into the profile.

## B. CONTINUOUS RUN INSTALLATION

### Provided Components

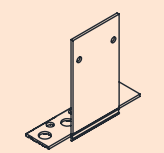

End Cap-(x2)

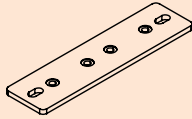

Alignement  
bracket Type A

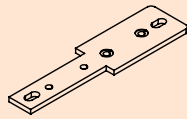

Alignement  
bracket Type B

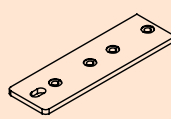

Alignement bracket  
Type A-CORNER

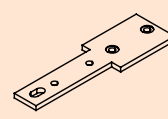

Alignement bracket  
Type B-CORNER

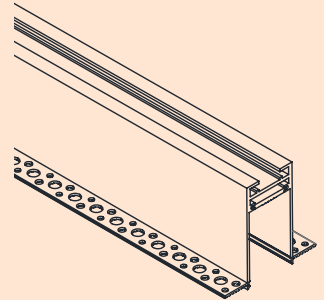

Specter trimless  
profile-(x1)

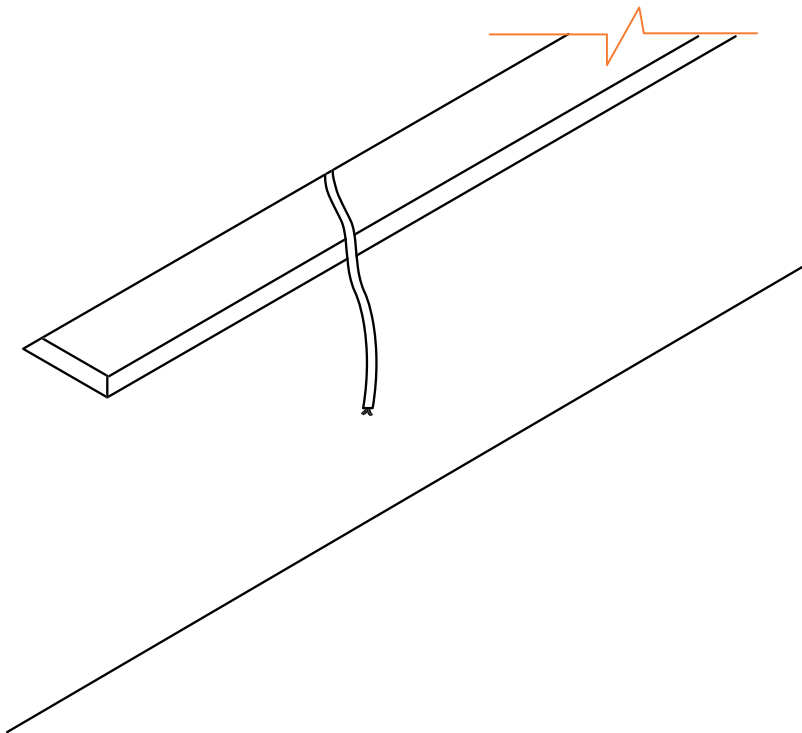

1.

- Cut ceiling opening (consult factory shop drawings for cut-out opening dimensions). Pull the low voltage cables through the ceiling opening.

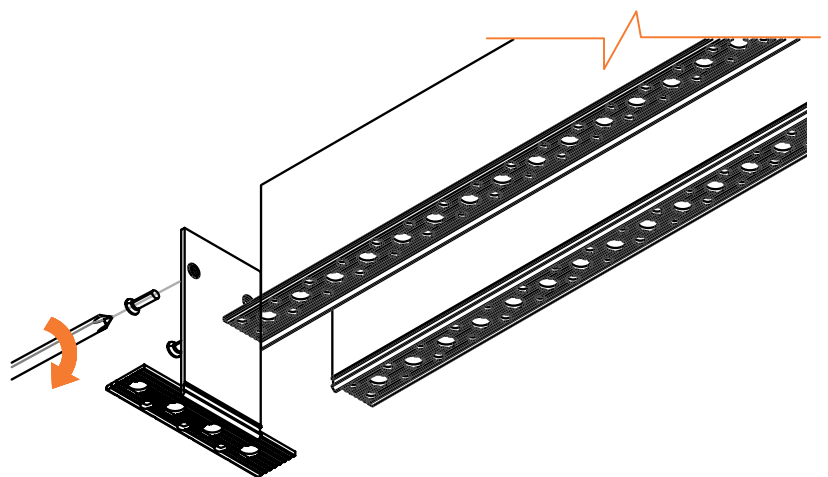

2.

- Screw the end cap to both sides of the continuous profile run.

## 3.

- Install alignment brackets (Type A) at the ends of all profiles using provided screws.

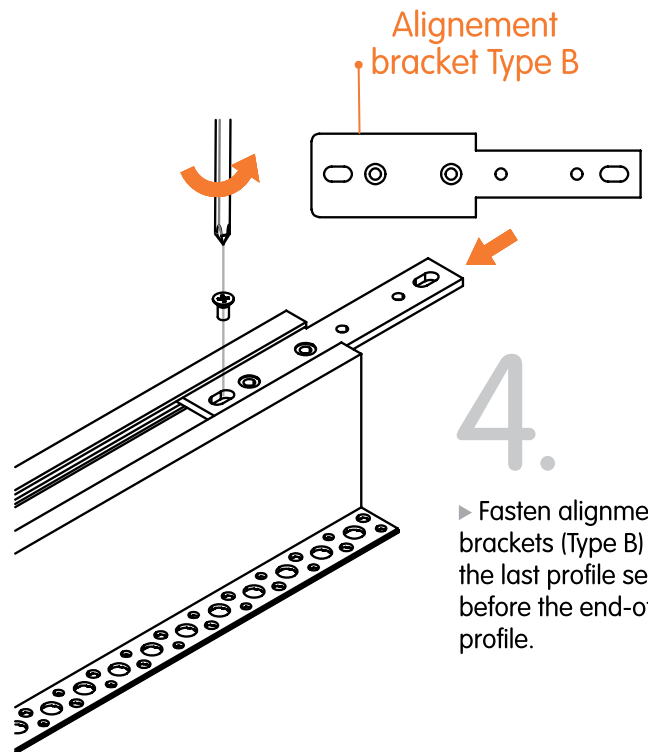
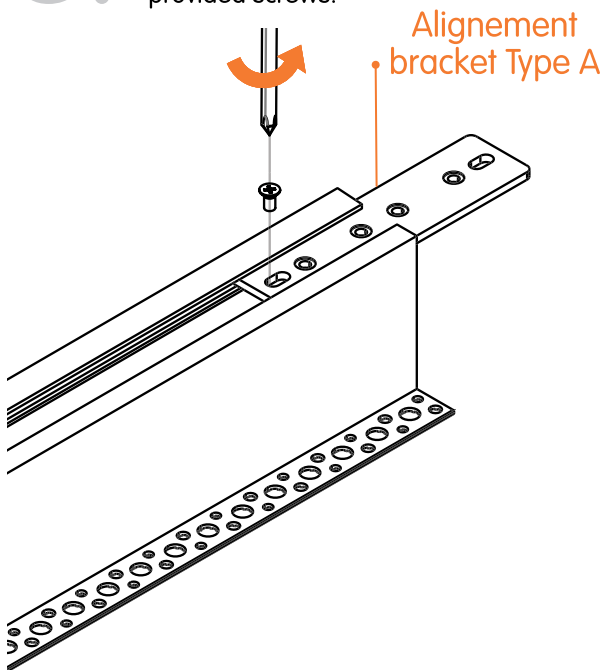

## 4.

- Fasten alignment brackets (Type B) to the last profile section before the end-of-run profile.

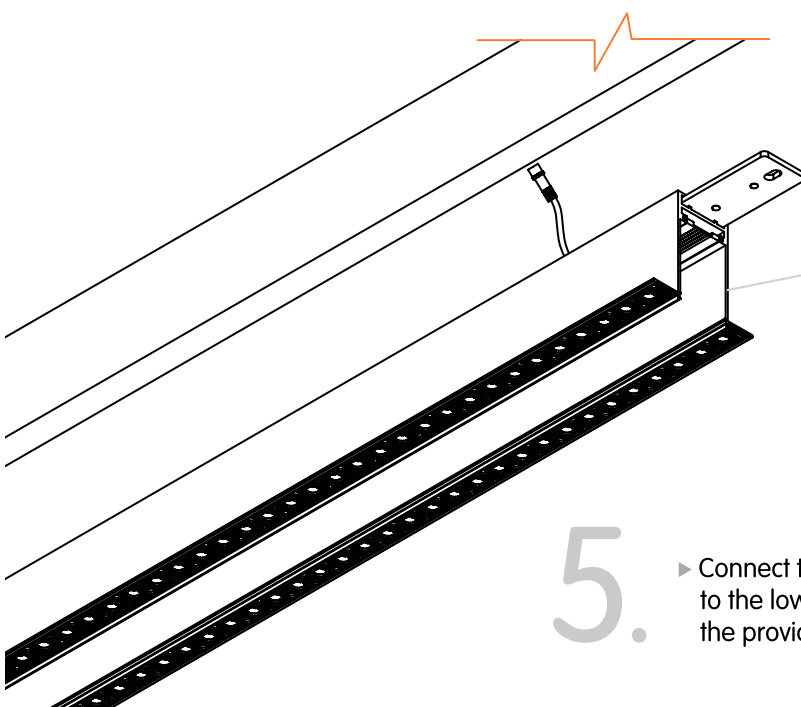

## 5.

- Connect the first of run profile to the low voltage feed using the provided connectors.



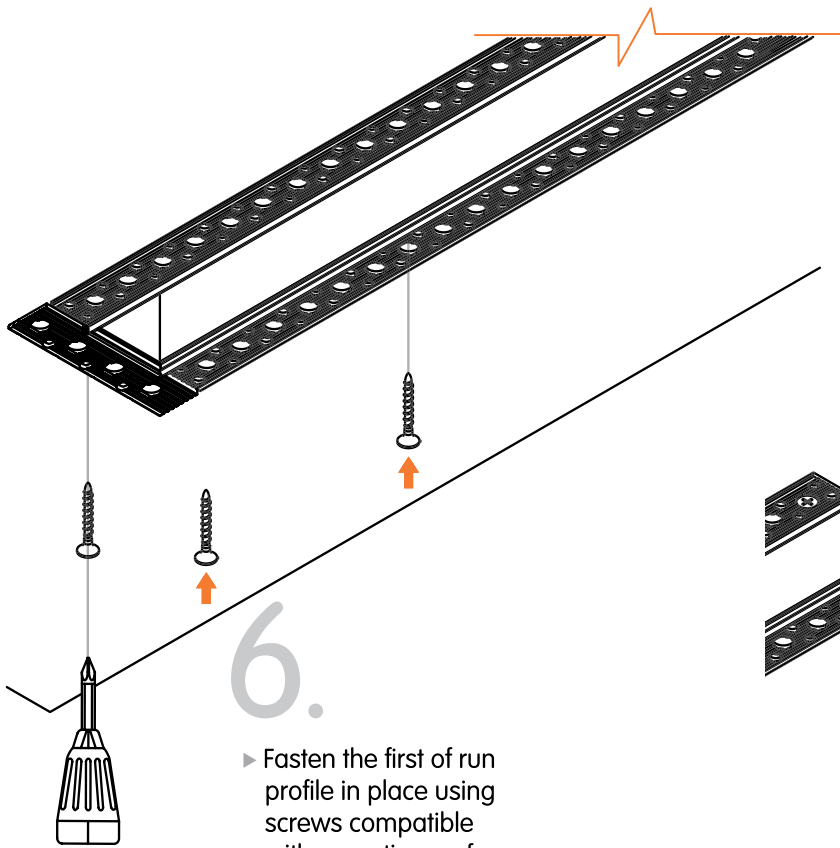

6.

- Fasten the first of run profile in place using screws compatible with mounting surface. Install per factory shop drawings.

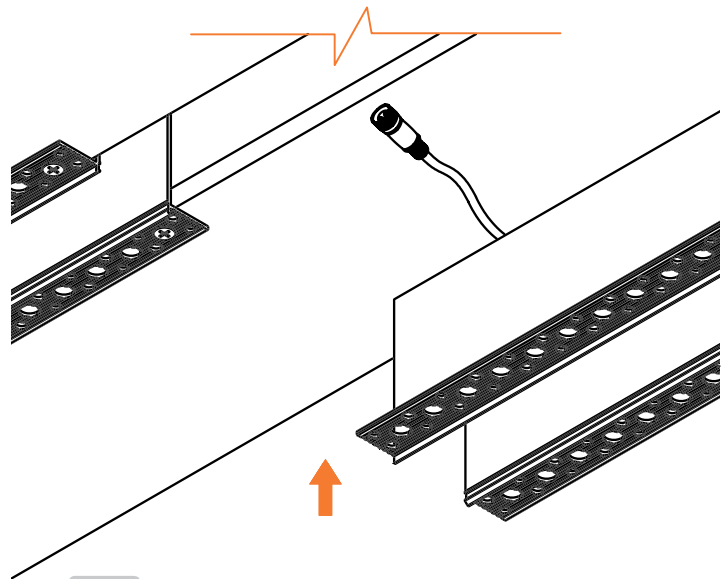

7.

- Insert neighboring profile into ceiling cut-out.

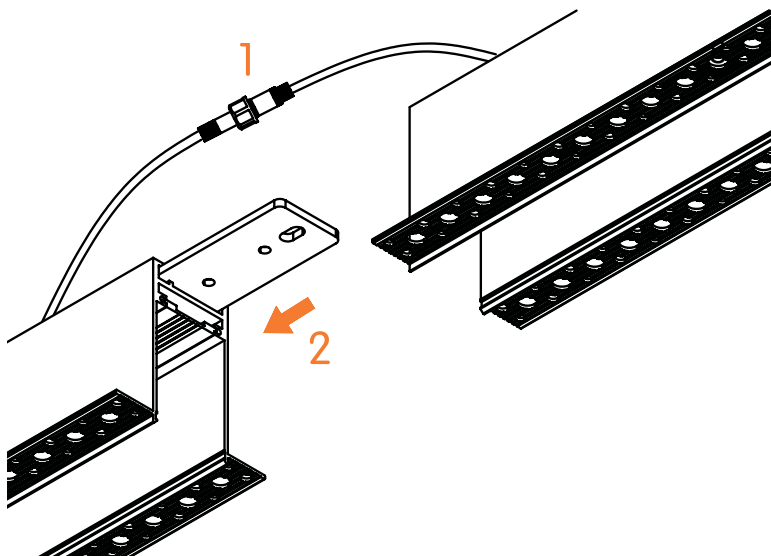

8.

- 1- Connect profiles together using the provided lead cables.
- 2- Slide middle of run profile into the alignment bracket of neighboring profile.
- Note: Refer to the factory shop drawings for the through wiring details.

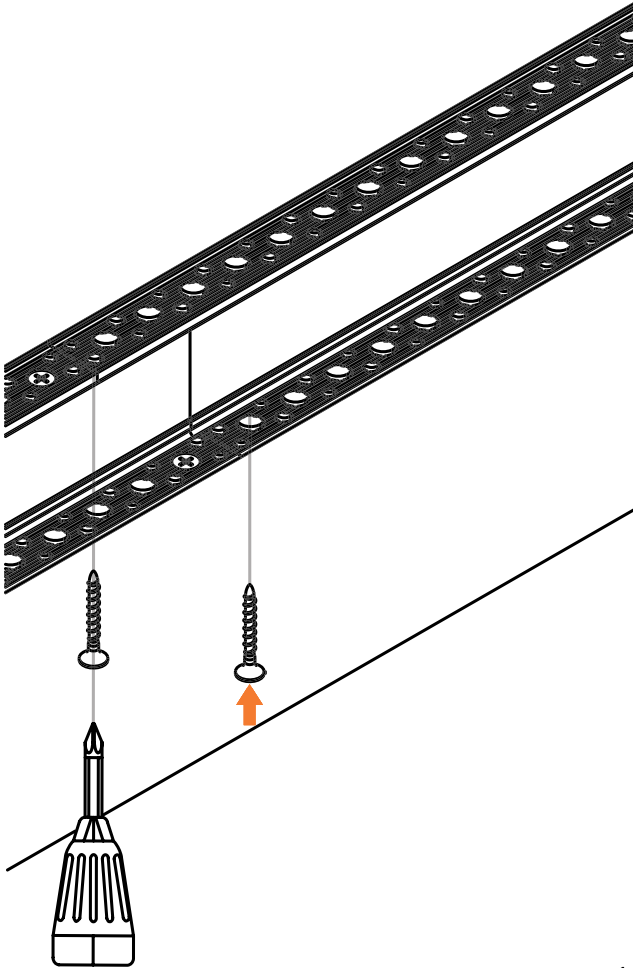

9. ▶ Repeat previous steps to install all profile sections except end of run profile.

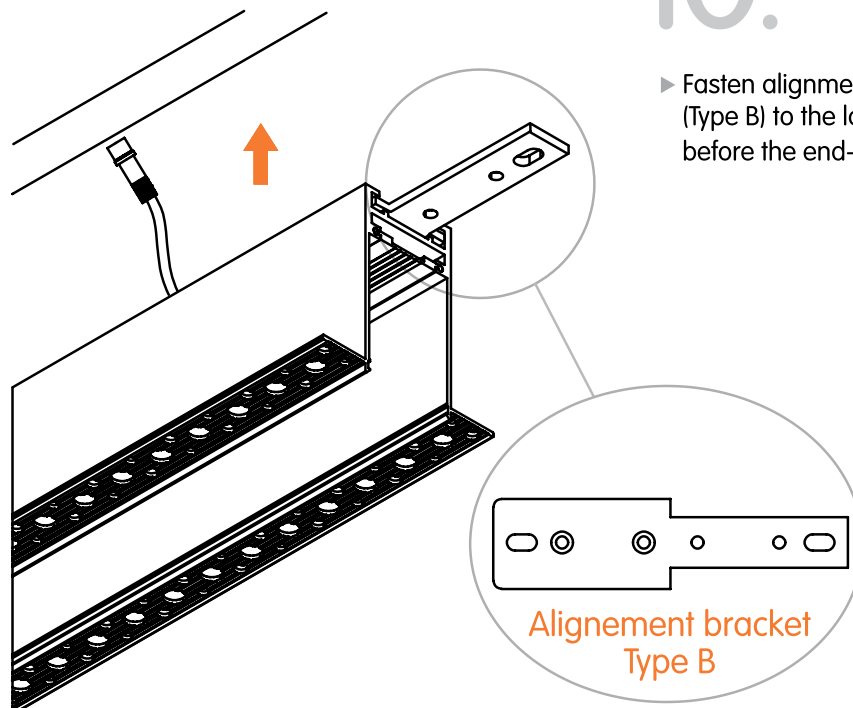

10.

- ▶ Fasten alignment bracket (Type B) to the last profile section before the end-of-run profile.

Alignement bracket  
Type B

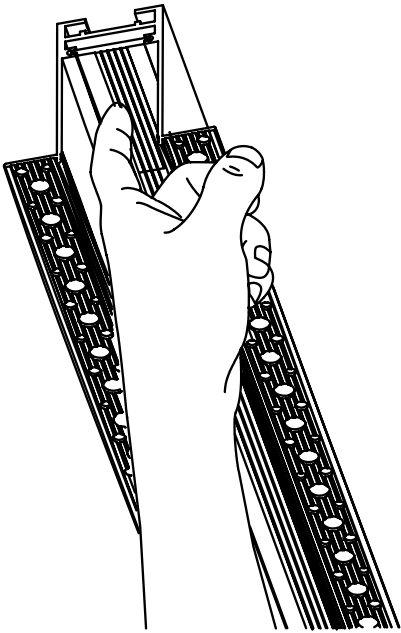

11. ▶ Press the side of decorative plates to remove from profile.

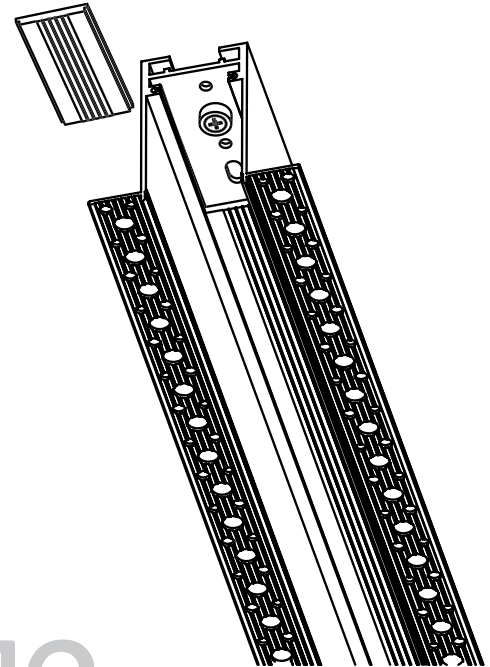

12. ▶ Remove the decorative plate.

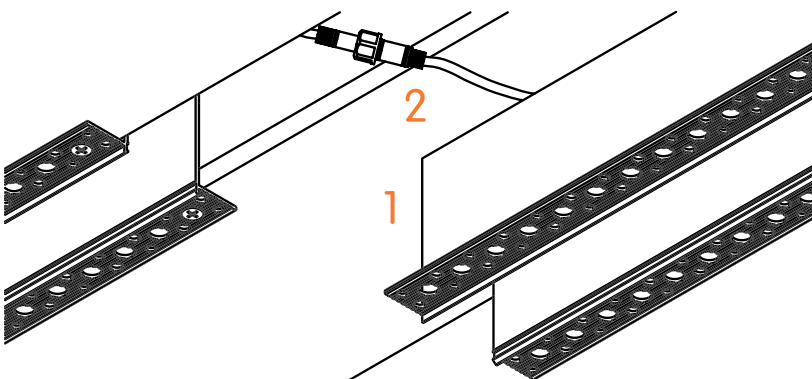

13. ▶ 1- Lift up the end of run profile.  
▶ 2- Connect profile cables together.  
▶ 3- Insert end-of-run profile through the alignment bracket (Type B) of the neighboring profile (refer to step 10 on page 9).

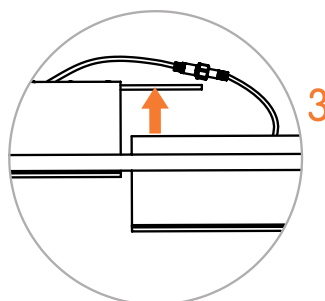

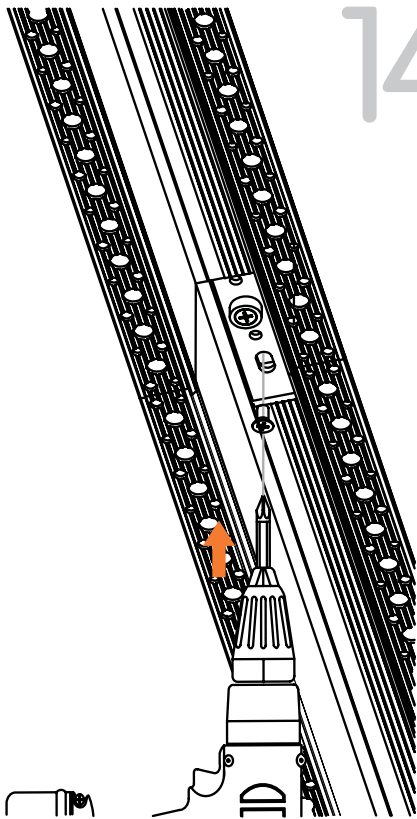

14.

- Fasten the end of run profile to the alignment bracket (Type B) of the neighboring profile.

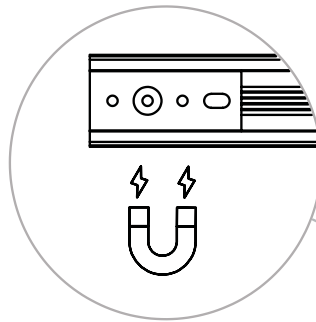

15.

- Clip the decorative plate in place.

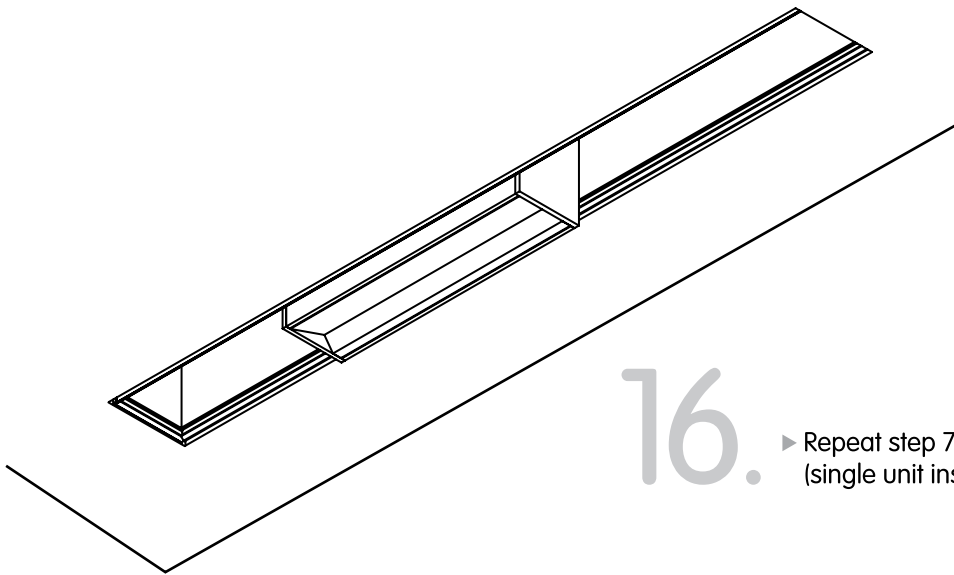
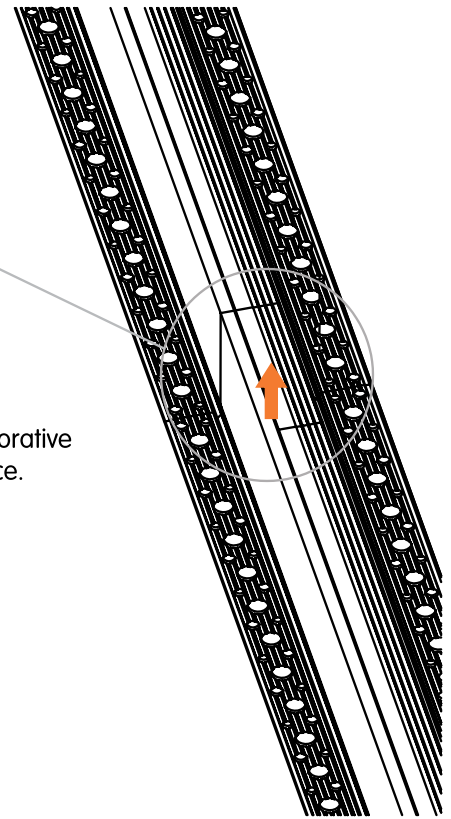

16.

- Repeat step 7-10 from Section A (single unit install).



**WARNING:** Do not exceed the rated wattage of the through wiring cables or the connectors.  
For all continuous runs, refer to factory shop drawing indicating exact dimensions and feed locations.

## C. CORNER CONNECTION

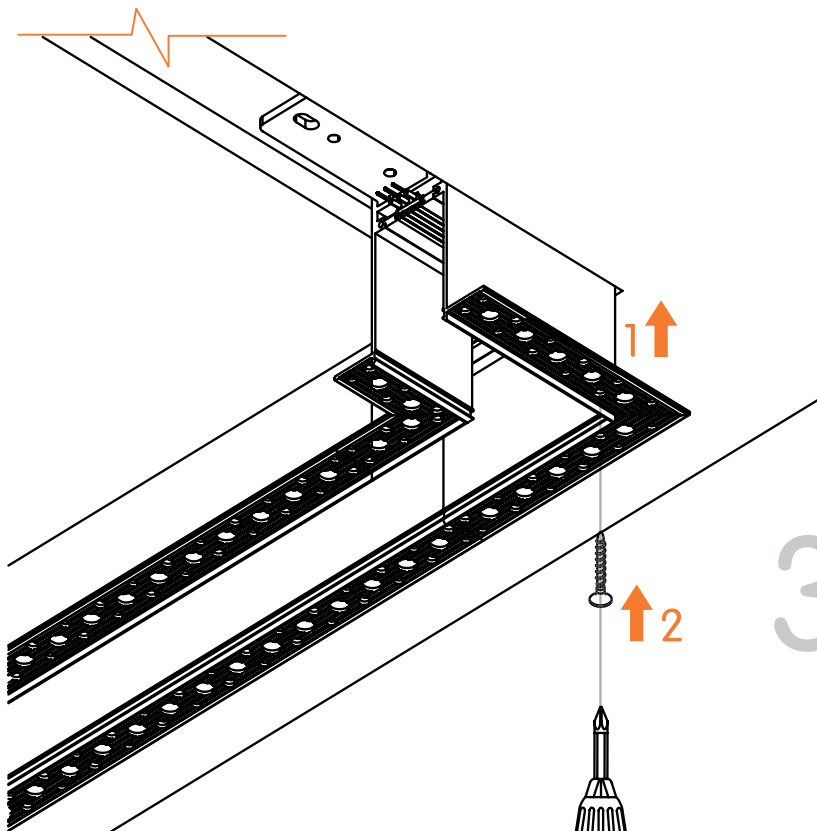
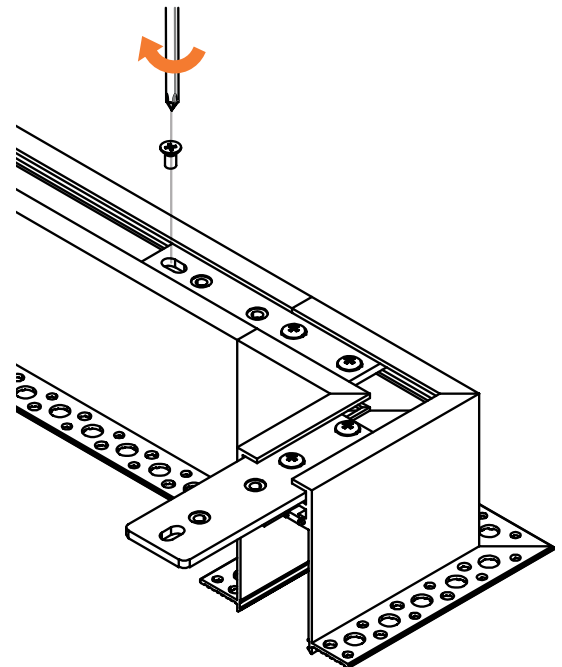
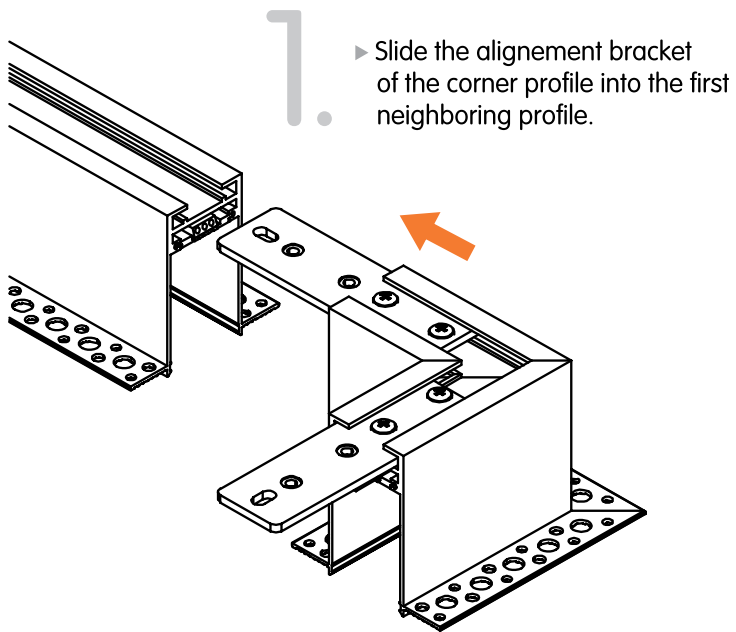



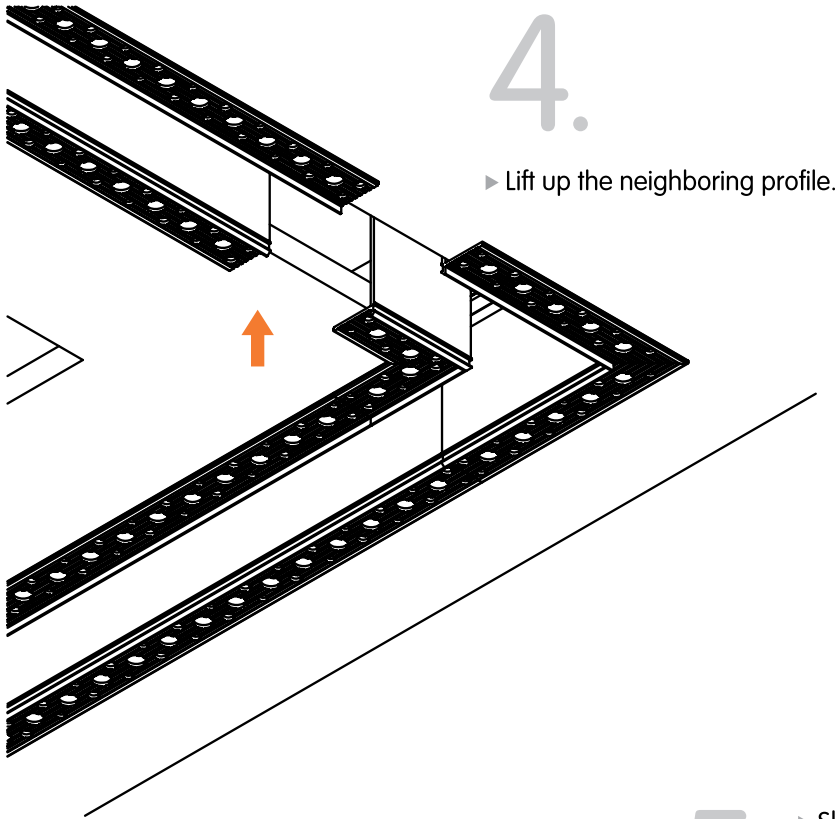

5. ► Slide the neighboring profile into the alignment bracket of the corner assembly and screw in place.

**NOTE :** Replace the alignment bracket (Type A-CORNER) by (Type B-CORNER) when the corner is at the end of run.

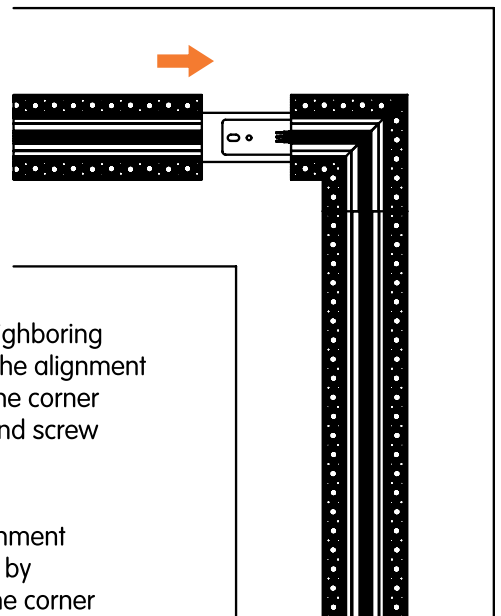

## ELECTRICAL CONTINUITY

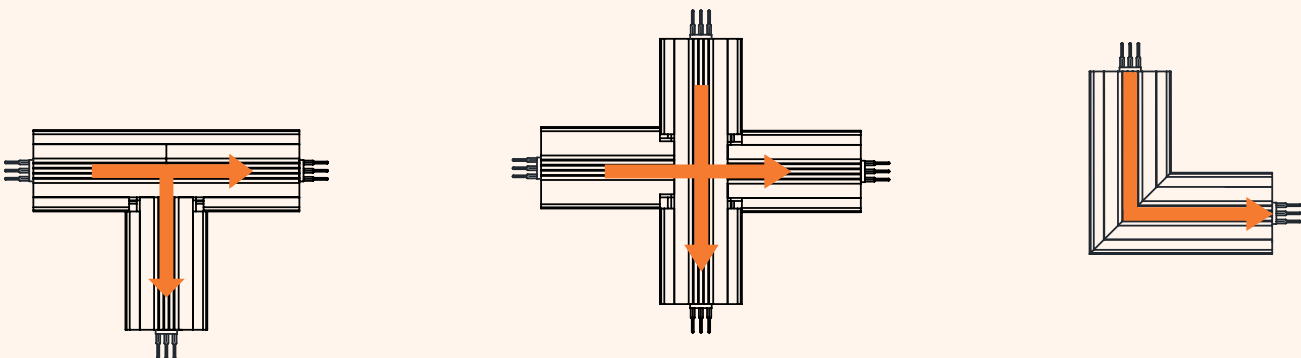

## D. WIRING DETAILS

### MAXIMUM RECOMMENDED DISTANCE FROM FIRST FEED TO REMOTE DRIVER (Track length considered 20ft)

Wire Gauge	Wattage	Maximum Lead Length
16 AWG (1.0 mm <sup>2</sup> )	60 W	100 ft (30.4 m)
	120 W	70 ft (21.3 m)
	150 W	50 ft (16.4 m)
	200 W	35 ft (10.7 m)
	300 W	15 ft (4.7 m)

### MAXIMUM RECOMMENDED LOAD RELATIVE TO LENGTH OF TRACK (Driver considered at 15ft from first feed)

Length of Track	Max. Load in W
165 ft (50 m)	100 W
130 ft (40 m)	120 W
100 ft (30.4 m)	150 W
70 ft (21.3 m)	200 W
35ft (10.7 m)	300 W
15 ft (4.7 m)	400 W

### ELV DIMMING WIRING DIAGRAM

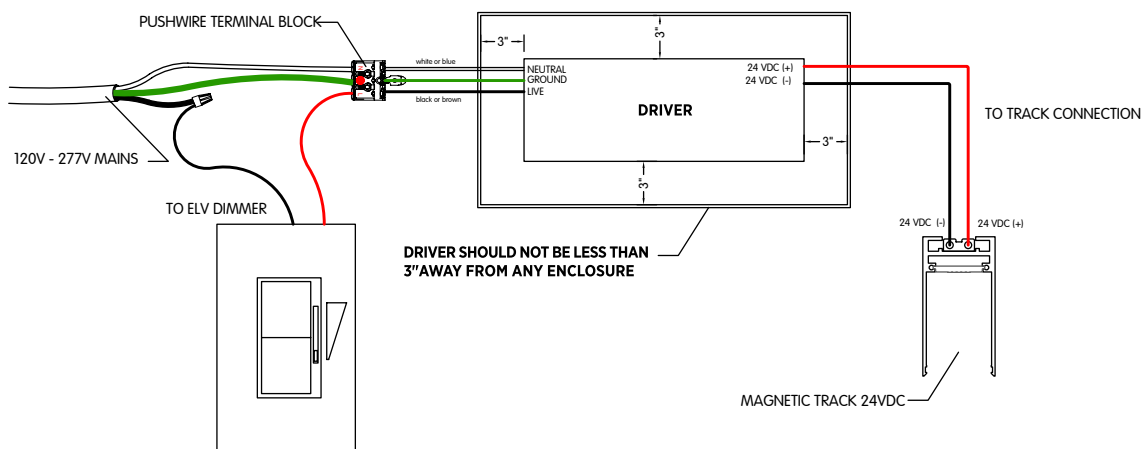

### DALI DIMMING WIRING DIAGRAM

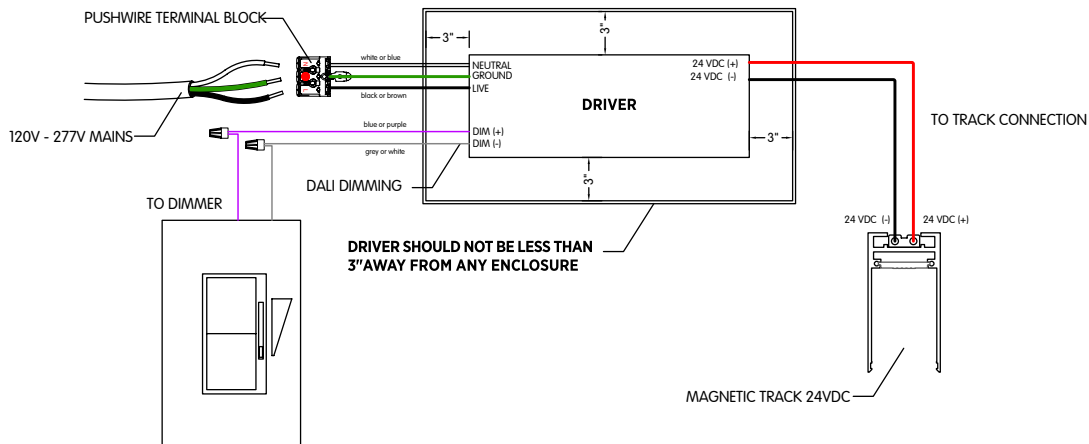

0-10V DIMMING WIRING DIAGRAM

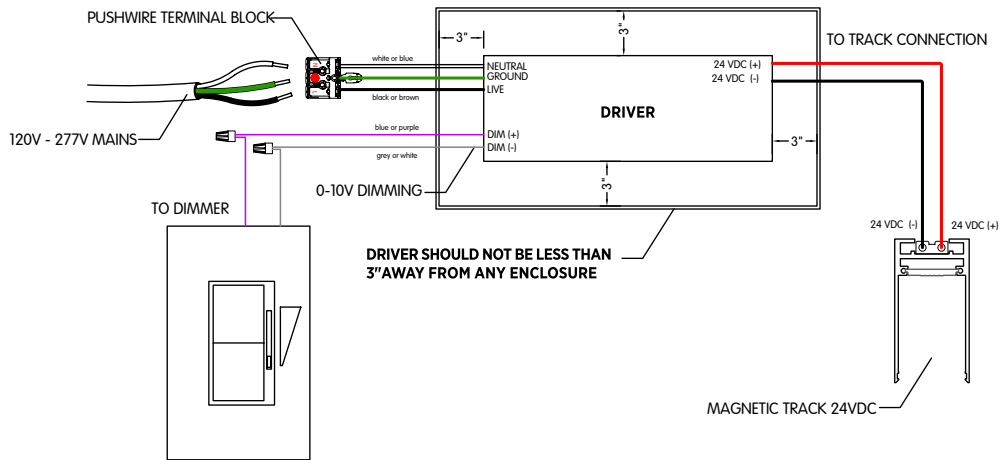

2 CIRCUIT TRACK WIRING DIAGRAM

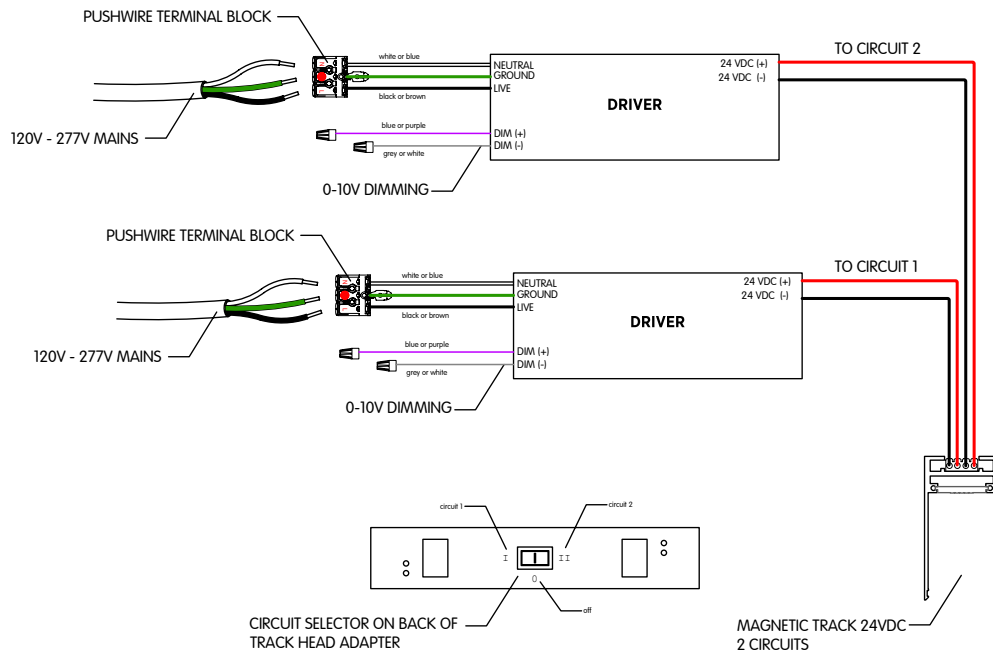

Failure to follow the wiring color coding and connectors pin labeling will void the fixtures warranty.